

# 312

Non-return foot valve

02 System

## Technical Data Sheet



## Description

Valve with very wide range of applications. It prevents water hammering, it's noiseless and the quality-price ratio is optimal.

- Operates in any position from horizontal to vertical ascending
- Minimum head loss
- Compactness
- Exceptional robustness
- Closing system : long back axial guiding and reduced displacement
- Sealing guaranteed by an EPDM seal
- Return spring



### 312

Non-return foot valve - 02 System

| DN |     | PN    | PFA<br>in bar | PS in bar |    |    |    | Cat. | Ref.            | Weight<br>Kg |
|----|-----|-------|---------------|-----------|----|----|----|------|-----------------|--------------|
| "  | mm  |       |               | L1        | L2 | G1 | G2 |      |                 |              |
| 5  | 125 | 10/16 | 16            | 16        | 16 | x  | x  | 4.3  | <b>149B2720</b> | 19           |
| 6  | 150 | 10/16 | 16            | 13        | 16 | x  | x  | 4.3  | <b>149B2721</b> | 28           |
| 8  | 200 | 16    | 16            | 10        | 16 | x  | x  | 4.3  | <b>149B2722</b> | 48           |
| 10 | 250 | 16    | 16            | 10        | 16 | x  | x  | I    | <b>149B2723</b> | 90           |
| 12 | 300 | 16    | 16            | 10        | 16 | x  | x  | I    | <b>149B2724</b> | 133          |
| 14 | 350 | 16    | 16            | 10        | 16 | x  | x  | I    | <b>149B2725</b> | 226          |
| 16 | 400 | 16    | 16            | 10        | 10 | x  | x  | I    | <b>149B2726</b> | 343          |

#### Important notice :

The indicated pressure for the different categories of fluids (L1/L2/G1/G2) is under no condition a guarantee of use. Therefore, it is essential to validate the use of products under given operating conditions. The operating instructions are available on our web site [www.socla.com](http://www.socla.com) or by requesting from our sales department.

#### Technical features

|   |   |
|---|---|
| Operating temperature                           | -10 °C to 80°C, for temperatures over 80°C consult us |
| Permissible operating pressure (PFA) in water   | See table above                                       |
| Maximum permissible pressure (PS) other mediums | See table above                                       |
| Connection                                      | Flange drilled PN (see table)                         |
| Mediums   | Clear liquids   |

#### Nomenclature and materials

| N° | Description    | Materials                         |
|----|----------------|-----------------------------------|
| 1  | Body           | Cast iron / Epoxy                 |
| 2  | Ring           | Bronze                            |
| 3  | Guide          | DN 50<br>Others DN                |
| 4  | Spring         | Stainless steel                   |
| 5  | Seal           | EPDM                              |
| 6  | Closing system | DN 50-65 : one-piece<br>Others DN |
| 7  | Stem           | Bronze                            |
| 8  | Screw          | DN 50 à 150<br>DN 200 à 400       |
| 9  | Strainer       | Galvanised steel                  |

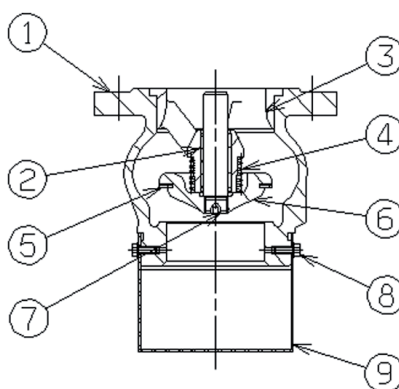

## Approvals

**ACS**



PED 2014/68/UE



### International construction Standards :

Directive 2014/68/UE

Flange drilling according to EN 1092-2

## Application

Clear water pumping.

## Operation

### Direction for use :

- Solid line : Valve completely open
- Dotted line : opening stage of valve

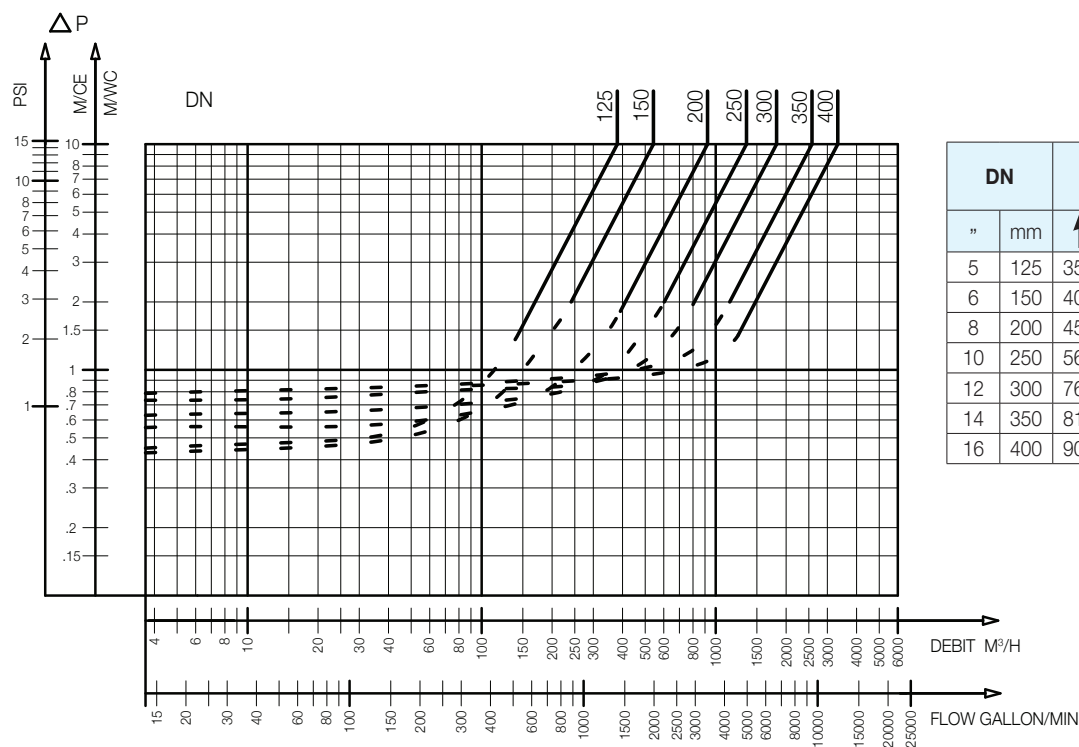

312 - Headloss chart

# Sizing

| A  |     | B   | C   | D   |
|----|-----|-----|-----|-----|
| "  | mm  | mm  | mm  | mm  |
| 5  | 125 | 333 | 254 | 217 |
| 6  | 150 | 373 | 285 | 256 |
| 8  | 200 | 483 | 343 | 336 |
| 10 | 250 | 572 | 406 | 416 |
| 12 | 300 | 652 | 482 | 486 |
| 14 | 350 | 771 | 533 | 580 |
| 16 | 400 | 876 | 597 | 676 |

| DN      | Perforation | Center distance |
|---------|-------------|-----------------|
| "       | mm          | mm              |
| 5 to 6  | 8           | 12              |
| 8 to 16 | 10          | 14              |

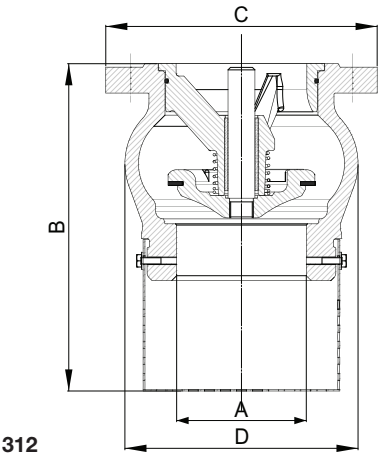

The descriptions and photographs contained in this product specification sheet are supplied by way of information only and are not binding.

Socla reserves the right to carry out any technical and design improvements to its products without prior notice. Warranty : All sales and contracts for sale are expressly conditioned on the buyer's assent to Socla terms and conditions found on its website at [www.socla.com](http://www.socla.com). Socla hereby objects to any term, different from or additional to Socla terms, contained in any buyer communication in any form, unless agreed to in a writing signed by an officer of Socla.



**Socla sas**  
 365 rue du Lieutenant Putier • 71530 Virey-Le-Grand • France  
 Tel. +33 03 85 97 42 00 • Fax +33 03 85 97 42 42  
[contact@wattswater.com](mailto:contact@wattswater.com) • [www.socla.com](http://www.socla.com)  
 ISO 9001 version 2015 / ISO 18001  
 © 2025 Socla