

Technical data sheet

Type V665 PAP

Ball valves

Applications and general features



- Can equip on all types of installations from heating systems, home water installations to heavy duty industrial applications at high pressure and temperature.
- Reduce bore

Technical description

DN		PFA bar	References
"	mm		
1/4	8	20	149B 5112
3/8	10	20	149B 5113
1/2	15	20	149B 5114
3/4	20	20	149B 5115
1	25	20	149B 5116

- **Connection** : Female/Female, BSPP threaded
- **Permissible operating pressure PFA - water-** (for supply, distribution and disposal of water) : See table
- **θ** Mini. 0 °C
Maxi. 120 °C
- **Mediums** : Drinking water and hot water
- **Approvals** : ACS
- **International construction Standards** :
Thread connection according to EN ISO 228-1

Overall dimensions

DN		B	D	E	Weight
"	mm	mm	mm	mm	kg
1/4	8	40	32	49	0,084
3/8	10	41	32	49	0,084
1/2	15	46	39	56	0,187
3/4	20	51	41	56	0,124
1	25	63	46	80	0,284

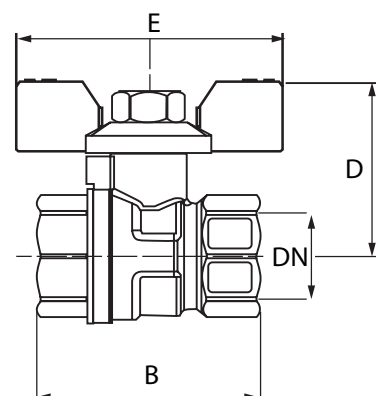

Technical data sheet Type V665 PAP - Ball valve

Spare parts list and materials

Nb	Description	Materials
1	BODY	Brass
2	NIPPLE	Brass
3	BALL	Brass
4	SEAT SEAL	PTFE
5	STEM	Brass
6	STEM SEAL	NBR
7	HAND NUT	ZAMAK
8	LOCKING SCREW	Steel

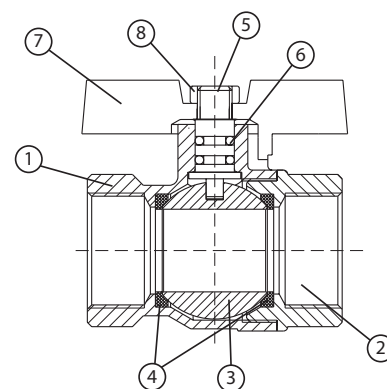

Headloss charts

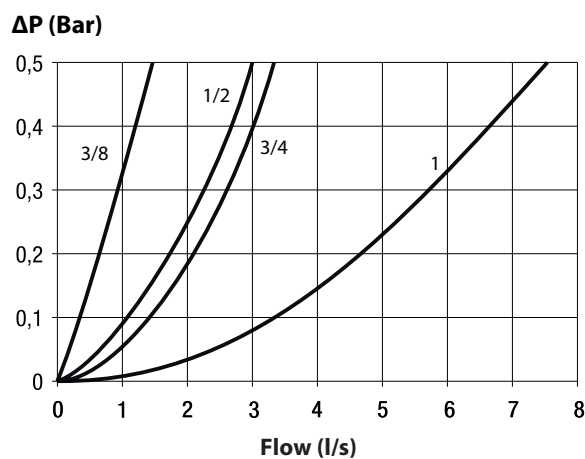

Socla can accept no responsibility for possible errors in catalogue, brochures and other printed material. Socla reserve the right to alter its products without notice. This also applies to products already agreed. All trademarks in this material are the property of the respective companies. All right reserved.

Socla SAS

365 rue du lieutenant Putier
71530 VIREY LE GRAND
Postal address : BP 10273
71107 CHALON SUR SAONE Cedex

Tel : 33 3 85 97 42 52
Fax : 33 3 85 97 97 42
<http://www.socla.com>
e-mail : contact@socla.com