

Technical data sheet

Type V3000B

Ball valve

Applications and general features



- Can equip on all types of installations from heating systems, home water installations to heavy duty industrial applications at high pressure and temperature.
- Full bore
- With drain cock and plug 1/4".

Technical description

DN		PFA bar	References
"	mm		
1/2	15	25	149B 5328
3/4	20	25	149B 5329
1	25	25	149B 5330

- **Connection** : Female/Female, BSPP threaded
- **Permissible operating pressure PFA - water-** (for supply, distribution and disposal of water) : See table
- **θ** Mini. -20 °C
Maxi. 140 °C
- **Mediums** : Drinking water and hot water
- **Approvals** : ACS
- **International construction Standards** :
Thread connection according to EN ISO 228-1

Overall dimensions

DN		B	D	E	Weight
"	mm	mm	mm	mm	kg
1/2	15	55	49	93	0,246
3/4	20	63	53	93	0,316
1	25	73	61	113	0,509

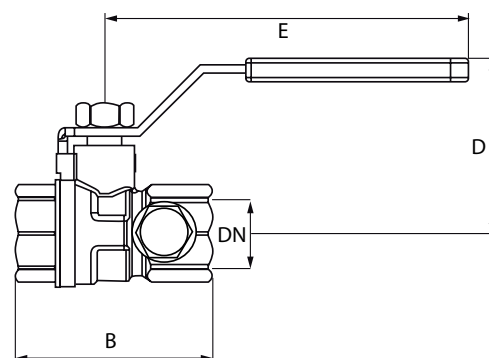

Technical data sheet Type V3000B - Ball valve

Spare parts list and materials

N°	Désignation	Matériaux
1	BODY	Brass
2	COUPLING	Brass
3	BALL	Brass
4	SEAT SEAL	PTFE
5	STEM	Brass
6	STUFFING BOX	NBR
7	HAND LEVER	Steel + LDPE
8	LOCKING SCREW	Steel
9	CAP	Brass
10	MANUEL AIR VENT	Brass

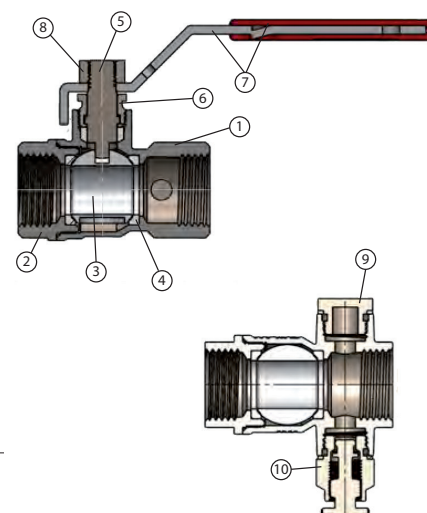

Headloss charts

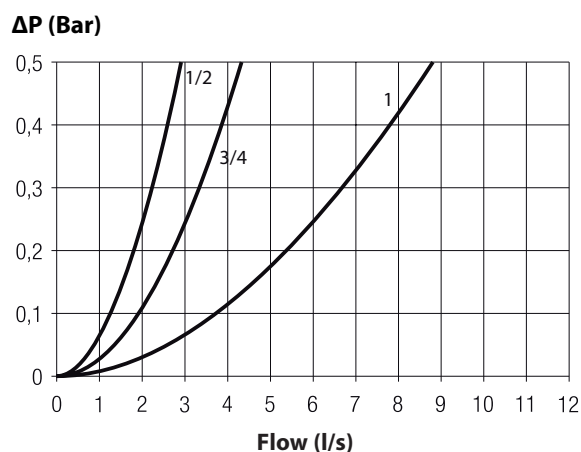

Socla can accept no responsibility for possible errors in catalogue, brochures and other printed material. Socla reserve the right to alter its products without notice. This also applies to products already agreed. All trademarks in this material are the property of the respective companies. All right reserved.

Socla SAS

365 rue du lieutenant Putier
71530 VIREY LE GRAND
Postal address : BP 10273
71107 CHALON SUR SAONE Cedex

Tel : 33 3 85 97 42 52
Fax : 33 3 85 97 97 42
<http://www.socla.com>
e-mail : contact@socla.com