

## Technical data sheet

### Type AKB2

#### Membrane solenoid valves

#### Applications and special features



- Membrane solenoid valve, direct action (pilot) normally closed, 2 ways.
- Absorbed power : 9 W CA/15 W CC.
- Viscosity : max 50cSt
- Ambient temperature : max. +40°C
- Protection : IP 65 with connector.
- Solenoid valve delivered with standard coil 220/50 Hz ref 5290 or 24V/50Hz ref 5292 or 24VDC ref 5296, and with a connector.

#### Technical description

| DN  |     | 220V/50Hz<br>9W | 24V/50Hz<br>9W | 24VDC<br>15W |
|-----|-----|-----------------|----------------|--------------|
| "   | mm  |                 |                |              |
| 1/8 | 3   | 149B 6774       | 149B 6779      | 149B 6784    |
| 1/4 | 3   | 149B 6775       | 149B 6780      | 149B 6785    |
| 1/4 | 4,5 | 149B 6776       | 149B 6781      | 149B 6786    |
| 3/8 | 4,5 | 149B 6777       | 149B 6782      | 149B 6787    |
| 1/2 | 8   | 149B 6778       | 149B 6783      | 149B 6788    |

**Important :**  
Every technical data concerns the standard coils.  
All our solenoid valves can be delivered **ON DEMAND** with a different coil.

- **Connection :** Female/female, BSP thread
- **Permissible operating pressure PFA - water-** (for supply, distribution and disposal of water) : See table 2
- **θ:** Mini. - 10 °C  
Maxi. + 100 °C
- **Mediums :** Liquids and neutral gas : water, oil, compressed air, neutral media.

#### Overall dimensions

| Connection<br>FF " | Passage | B  | H  | H1 | L  | Weight |
|--------------------|---------|----|----|----|----|--------|
|                    |         | mm | mm | mm | mm | kg     |
| 1/8                | 3       | 34 | 71 | 13 | 38 | 0,36   |
| 1/4                | 3       | 34 | 71 | 13 | 38 | 0,36   |
| 1/4                | 4,5     | 34 | 71 | 13 | 38 | 0,36   |
| 3/8                | 4,5     | 34 | 71 | 13 | 38 | 0,36   |
| 1/2                | 8       | 48 | 77 | 13 | 49 | 0,45   |

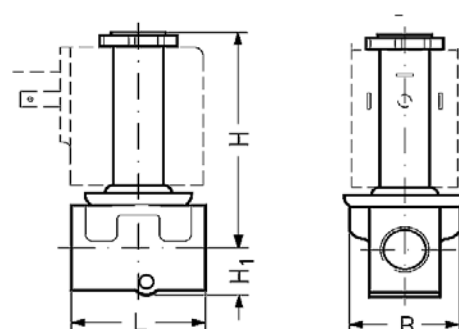

## Technical data sheet **Type AKB2 - Membrane solenoid valves**

### Working principle

#### Coil voltage disconnected (closed) :

When the voltage to the coil (5) is disconnected, the armature (2) with the valve plate (3) is pressed down against the valve orifice (4) by the closing spring (1) and the medium's pressure. The valve will be closed for as long as the voltage to the coil is disconnected.

#### Coil voltage connected (open)

When voltage is applied to the coil (5), the armature (2) with the valve plate (3) is lifted clear of the valve orifice (4). The valve is now open for unimpeded flow and will be open for as long as there is voltage to the coil.

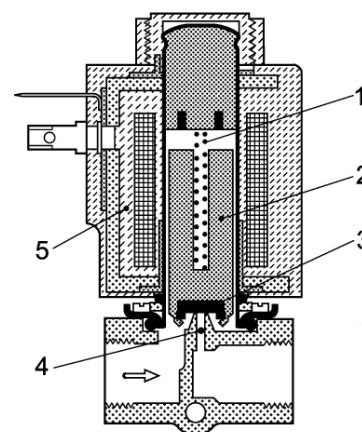

### Spare parts list and materials

|                 |                                        |
|-----------------|----------------------------------------|
| • Valve body    | : Brass N° 2.0402                      |
| • Armature      | : Stainless steel N° 1.4105/AISI 430FR |
| • Armature tube | : Stainless steel N° 1.4306/AISI 304L  |
| • Spring        | : Stainless steel 1.4310/AISI 301      |
| • Diaphragm     | : FKM                                  |

### Working principle

| DN<br>"      | Maxi. pressure<br>bar | Differential pressure - bar |            |             | Time<br>to open<br>m/s | Time<br>to close<br>m/s | Kv - m3/h | Class |
|--------------|-----------------------|-----------------------------|------------|-------------|------------------------|-------------------------|-----------|-------|
|              |                       | Mini                        | Maxi       |             |                        |                         |           |       |
|              |                       |                             | Coil 9W ca | Coil 15W cc |                        |                         |           |       |
| 1/8          | 35                    | 0                           | 15         | 9           | 20                     | 20                      | 0,30      | 3,3   |
| 1/4 - 3 mm   |                       |                             | 15         | 9           |                        |                         | 0,30      | 3,3   |
| 1/4 - 4,5 mm |                       |                             | 8          | 3,5         |                        |                         | 0,55      | 3,3   |
| 3/8          |                       |                             | 8          | 3,5         |                        |                         | 0,55      | 3,3   |
| 1/2          | 25                    |                             | 1,5        | 0,5         |                        | 30                      | 1         | 3,3   |

\* The indicated times concern the medium water - The exact time depends of pressure conditions.

Socla can accept no responsibility for possible errors in catalogue, brochures and other printed material. Socla reserve the right to alter its products without notice. This also applies to products already agreed. All trademarks in this material are the property of the respective companies. All right reserved.

### Socla SAS

365 rue du lieutenant Putier  
71530 VIREY LE GRAND  
Postal address : BP 10273  
71107 CHALON SUR SAONE Cedex

Tel : 33 3 85 97 42 52  
Fax : 33 3 85 97 97 42  
<http://www.socla.com>  
e-mail: [commerfr@socla.com](mailto:commerfr@socla.com)