

Technical data sheet

Type 882

Non return valve

System 02

Applications and special features



- Operates in any position
- Minimum head loss
- Silent, reliable sealing, compact
- Exceptional robustness
- Does not generate hammering
- Closing system : short back axial guiding for reduced displacement
- Sealing guaranteed by a flat seal
- Return spring

Technical description

Important notice :

The indicated pressure for the different categories of fluids (L1/L2/G1/G2) is under no condition a guarantee of use. Therefore, it is essential to validate the use of products under given operating conditions. The operating instructions are available on our web site www.socla.com or by requesting from our sales department.

DN "	mm	PFA in bar	PS in bar				Cat.	References	Vvs-nr
			L1	L2	G1	G2			
2 1/2	65	40	30	40	15	40	I	149B 3040	
2 1/2	65	40	40	40	40	40	II	149B 3040C2	
3	80	40	25	40	12	40	I	149B 3041	
3	80	40	40	40	40	40	II	149B 3041C2	
4	100	40	20	40	10	40	I	149B 3042	
4	10	40	40	40	40	40	II	149B 3042C2	
5	125	40	16	40	0,5	28	I	149B 3043	
5	125	40	40	40	28	40	II	149B 3043C2	
6	150	40	13	40	0,5	23	I	149B 3044	
6	150	40	440	40	23	33	II	149B 3044C2	
8	200	16	16	16	16	16	II	149B 3045*	
8	200	25	25	25	17	25	II	149B 007936**	
8	200	40	40	40	17	25	II	149B 007937***	
10	250	40	40	40	14	20	II	149B 3046****	
10	250	25	25	25	14	20	II	149B 007938**	

- Connection : Mounting between flanges, PN see table
- Permissible operating pressure PFA - water- (for supply, distribution and disposal of water) : See table
- Maximum Permissible pressure PS - other mediums: See table
- θ Mini. -10 °C
Maxi. 100 °C
- Mediums : Clear liquids, dry clean air
- Approvals : ACS PED 97/23/CE
- Other approval available : **WRAS** approved material : please consult us
- International construction Standards :
CE Conformity Directive 97/23/CE
Flange drilling according to EN1092-2

* PN 10-16 ASA 150
** PN 25
*** PN 40
**** PN 10-16-40 ASA 150

Overall dimensions

DN mm	B mm	C				Weight kg
		PN10/16	PN25	PN40	ASA150	
65	75	126	126	126	121	2,7
80	85	142	142	142	-	4
100	105	162	170	170	170	6
125	90	194	194	194	194	7
150	106	218	222	222	222	11
200	140	273	-	-	273	22
200	140	-	285	-	-	22
200	140	-	-	289	-	22
250	200	-	339	-	-	47
250	200	328	-	352	328	47

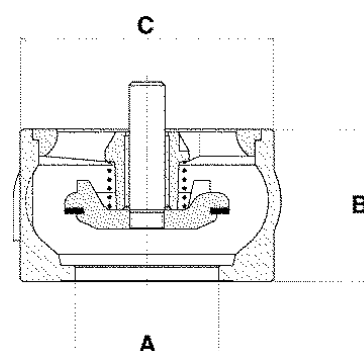

Technical data sheet Type 882 - Non return valve

Spare parts list and materials

Nb	Description	Materials	EURO	ANSI
1	CASING	Cast iron + epoxy	EN-GJS-400.15	ASTM A 536 60-40-18
2	RING	Bronze	CuSn12	
3	GUIDE	Cast iron + epoxy	EN-GJL-250	ASTM A 48 35 B
4	SPRING	Stainless steel	X10CrNi18-8	AISI 302
5	SEAL	EPDM		
6	CLOSING SYSTEM DN65	Bronze	CuSn5Zn5Pb5-C	ASTM B 505
	Other DN	Cast iron + epoxy	EN-GJL-250	ASTM A 48 35 B
7	STEM	Bronze	CuSn5Zn5Pb5-C	ASTM B 505

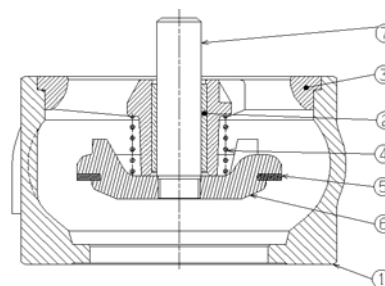

Working principle

DN		Opening pressure in mm/CE				Kv	ζ
"	mm	↑	↓	↔	without spring	m³/H	
2 1/2	65	400	250	50		136,00	1,50
3	80	350	200	50		200,00	1,60
4	100	300	190	50		265,00	2,30
5	125	250	20	100		265,00	5,70
6	150	200	15	100		347,00	6,80
8	200	200	15	100		550,00	8,30
8	200	200	15	100		550,00	8,30
8	200	200	15	100		550,00	8,30
10	250					916,00	7,30
10	250					916,00	7,30

Direction for use :

- Solid line : Valve completely open
- Dotted line : opening stage of valve

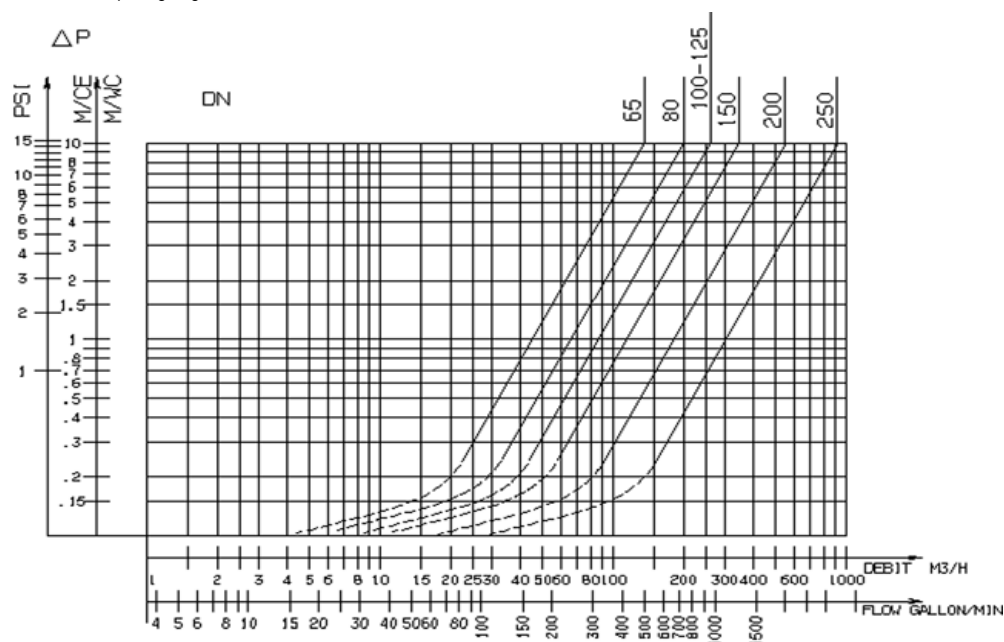

Socla can accept no responsibility for possible errors in catalogue, brochures and other printed material. Socla reserve the right to alter its products without notice. This also applies to products already agreed. All trademarks in this material are the property of the respective companies. All right reserved.

Socla SAS

365 rue du lieutenant Putier
71530 VIREY LE GRAND
Postal address : BP 10273
71107 CHALON SUR SAONE Cedex

Tel : 33 3 85 97 42 52
Fax : 33 3 85 97 97 42
<http://www.socla.com>
e-mail: commerfr@socla.com