

Technical data sheet

Type 802T

Non-return valve

System W

Applications and special features



- Operates in any position
- Easy mounting and dismounting, space-saving
- Minimum head loss
- Does not generate hammering
- Closing system : disc with parabolic edges with return spring ; lateral guiding by 3 or 4 ribs.
- Metal/metal seal (machined trim)
- Using these check valves on networks equipped with piston pumps or compressors is not recommended.

Technical description

Important notice:

The indicated pressure for the different categories of fluids (L1/L2/G1/G2) is under no condition a guarantee of use. Therefore, it is essential to validate the use of products under given operating conditions.

DN	PFA	PS in bar				Cat.	References	Vvs-nr
		in bar	L1	L2	G1	G2		
1 1/4	32	16	16	16	16	16	I 149B 2413T	
1 1/2	40	16	16	16	16	16	I 149B 2414T	
2	50	16	16	16	16	16	I 149B 2415T	

For DN 1/2, 3/4 and 1" : see type 812XT

- **Connection** : Between flanges female/female, BSP threaded
- **Permissible operating pressure PFA - water-** (for supply, distribution and disposal of water) : See table
- **Maximum Permissible pressure PS - other mediums**: See table

• **θ** Mini. -10 °C
Maxi. 200 °C

• **Mediums** : Clear liquids

• **Leakage rate** : according to EN 12266-1 rate E

• **Approvals** : ACS PED 2014/68/UE

- **International construction Standards** :
CE Conformity Directive 97/23/CE
Thread connection according to NFE 03-005 - ISO 228
Overall dimensions without nipples according to EN558-1 series 49

Overall dimensions

A		B	C	D	Weight
"	mm	mm	mm	mm	kg
1 1/4	32	100	53	102	1
1 1/2	40	105,5	61	108	2,2
2	50	118	73	127	3,2

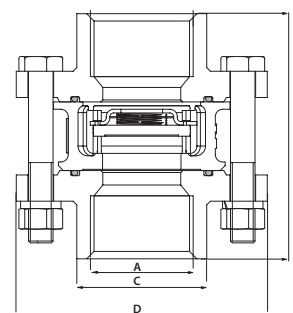

Technical data sheet Type 802T - Non-return valve

Spare parts list and materials

Nb	Description	Materials	EURO	ANSI
1	CASING DN 1"1/4 to 2"	DZR brass	CuZn35Pb2Al-C	
2	CLOSING SYSTEM	Stainless steel	X2CrNiMo17-12-2	ANSI 316L
3	SPRING	Stainless steel	X10CrNi18-8	ANSI 302
4	STOP-GUIDE	Stainless steel	X2CrNiMo17-12-2	ANSI 316L
5	COUNTER-FLANGE	Stainless steel	X5CrNiMo19-11-2	ANSI 316
6	SCREW	Stainless steel	X5CrNiMo17-12-2	ANSI 316
7	NUT	Stainless steel	X5CrNiMo17-12-2	ANSI 316
8	WASHER	Stainless steel	X5CrNiMo17-12-2	ANSI 316
9	SEAL	PTFE		

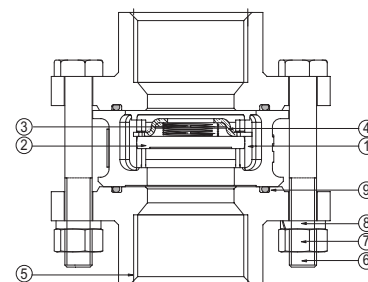

Working principle

DN		Opening pressure mm/WC				Kv	ζ
"	mm	↑	↓	↔	Without spring	m³/H	
1 ^{1/4}	32	190	130	160	30	18,00	5,0
1 ^{1/2}	40	200	120	160	40	28,00	5,1
2	50	210	110	160	50	40,10	6,1

Direction for use :

- Solid line : Valve completely open
- Dotted line : opening stage of valve

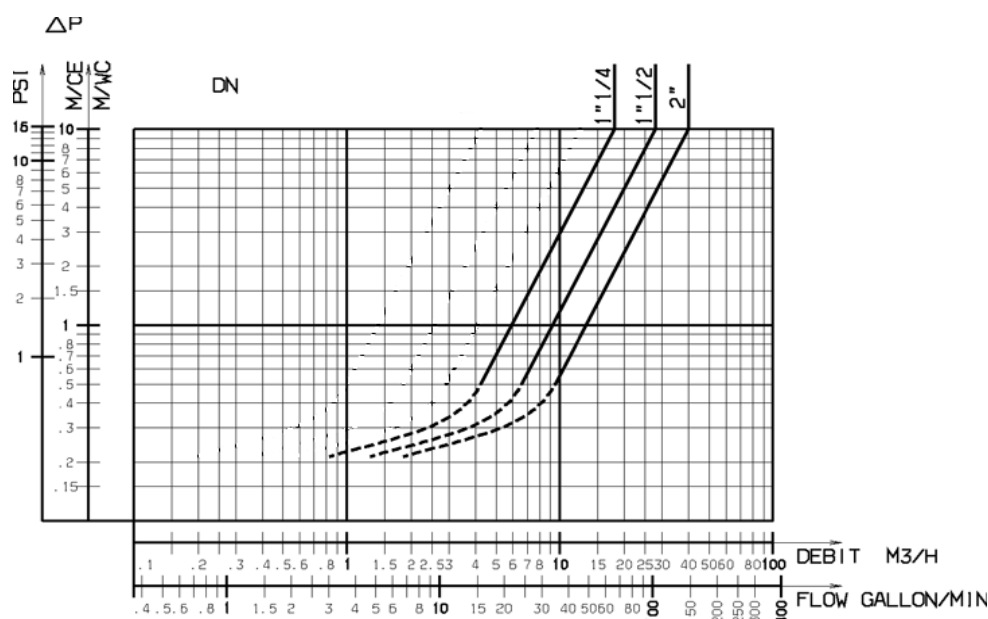
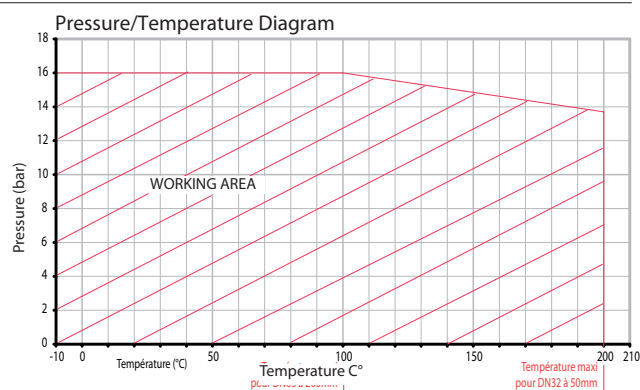

Socla can accept no responsibility for possible errors in catalogue, brochures and other printed material. Socla reserve the right to alter its products without notice. This also applies to products already agreed. All trademarks in this material are the property of the respective companies. All right reserved.

Socla SAS

365 rue du lieutenant Putier
71530 VIREY LE GRAND
Postal address : BP 10273
71107 CHALON SUR SAONE Cedex

Tel : 33 3 85 97 42 52
Fax : 33 3 85 97 97 42
<http://www.socla.com>
e-mail: contact@wattswater.com