

Technical data sheet

Type 696V

Non return valve

System 05

Applications and special features



- Can be installed horizontally or vertically facing upwards.
- Compact
- Robust and reliable
- Simple design, easy installation

Technical description

Important :

The indicated pressure for the different categories of fluids (L1/L2/G1/G2) is under no condition a guarantee of use. Therefore, it is essential to validate the use of products under given operating conditions.

NB : PN16 version : Please consult us

DN mm	PN	PFA bar	PS - bar				Cat.	References	Vvs-nr
			L1	L2	G1	G2			
40	10/16	16	10	10	10	10	I	149F021325	
50	10/16	16	10	10	10	10	I	149F021326	
65	10/16	16	10	10	10	10	I	149F021327	
80	10/16	16	10	10	10	10	I	149F021328	
100	10/16	16	10	10	10	10	I	149F021329	
125	10/16	16	10	10	0,5	10	I	149F021330	
150	10/16	16	10	10	0,5	10	I	149F021331	
200	10	10	10	10	0,5	10	I	149F021332	
250	10	10	10	10	0,5	10	I	149F021333	
300	10	10	10	10	0,5	10	I	149F021334	

- **Connection** : Between flanges PN see table.
- **Permissible operating pressure PFA - water-** (for supply, distribution and disposal of water) : see table
- **Maximum permissible pressure PS -other mediums** : see table
- **Maximum service velocity** : 5m/s
- **θ** : Mini. -10 °C
Maxi. 150 °C
- **Mediums** : Clear liquids, see water, salted and aggressive solutions
- **Approvals** : PED 97/23/CE
- **International construction Standards** :
CE conformity Directive 97/23/CE
Flange drilling according to EN 1092 series 2

Overall dimensions

DN mm	A mm	D mm	E mm
40	22	94	16
50	32	106	16
65	42	129	16
80	53	144	16
100	71	162	16
125	94	194	16
150	114	220	19
200	164	275	28
250	199	331	32
300	240	380	38

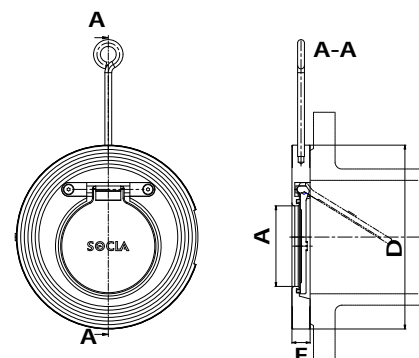

Technical data sheet Type 696V - Non return valve

Spare parts list and materials

Nb	Description	Materials	EURO	ANSI
1	CASING	Aluminium Bronze	EN1982CuAl10Fe5Ni5-C GS	
2	DISC	Aluminium Bronze	EN1982CuAl10Fe5Ni5-C GS	
3	DISC HOLDING	Aluminium Bronze	EN1982CuAl10Fe5Ni5-C GS	
4	SCREW	Stainless steel	EN10088-3 X5CrNi18-10	AISI 304
5	SEAL	FKM		

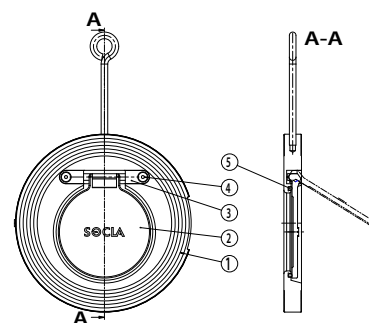

Working principle

DN	Opening pressure mm/WC	Kv	ζ
mm	near zero	m ³ /H	
40		17,3	13,76
50		49	4,19
65		93	3,25
80		141,8	3,3
100		218	3,34
125		412	2,29
150		514	3,06
200		1 069	2,23
250		1 569	2,54
300		2 459	2,14

Direction for use :

- Solid line : Valve completely open
- Dotted line : opening stage of valve

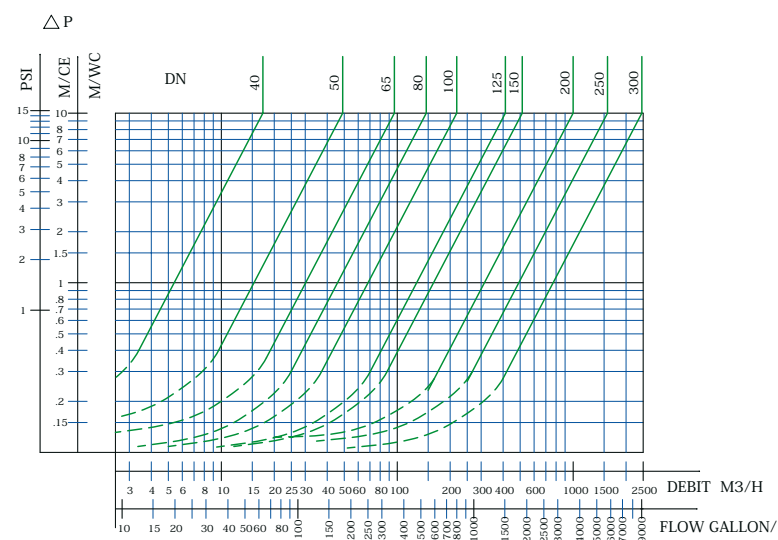

Socla can accept no responsibility for possible errors in catalogue, brochures and other printed material. Socla reserve the right to alter its products without notice. This also applies to products already agreed. All trademarks in this material are the property of the respective companies. All right reserved.

Socla SAS

365 rue du lieutenant Putier
71530 VIREY LE GRAND
Postal address : BP 10273
71107 CHALON SUR SAONE Cedex

Tel : 33 3 85 97 42 52
Fax : 33 3 85 97 97 42
<http://www.socla.com>
e-mail: commerfr@socla.com