

Technical data sheet

Type 422

Non return valve

System 02

Applications and special features



- Operates in any position
- Minimum head loss
- Silent, reliable sealing, compact
- Exceptional robustness
- Does not generate hammering
- Closing system : long back axial guiding for reduced displacement
- Sealing guaranteed by a flat seal
- Return spring
- Seat and closing system in bronze

Technical description

Important notice:

The indicated pressure for the different categories of fluids (L1/L2/G1/G2) is under no condition a guarantee of use. Therefore, it is essential to validate the use of products under given operating conditions.

DN "	mm	PN	PFA in bar	PS in bar				Cat.	References	Vvs-nr
				L1	L2	G1	G2			
2	50	10/16	16	16	16	16	16	I	149B 2679	
2 1/2	65	10/16	16	16	16	15	16	I	149B 2680	
3	80	10/16	16	16	16	12	16	I	149B 2681	
4	100	10/16	16	16	16	10	16	I	149B 2682	
5	125	10/16	16	16	16	0,5	16	I	149B 2683	
6	150	10/16	16	13	16	0,5	16	I	149B 2684	
8	200	10	10	10	10	0,5	10	I	149B 2685	
10	250	10	10	10	10	0,5	10	I	149B 2686	
12	300	10	10	10	10	0,5	10	I	149B 2687	
14	350	10	10	10	10	0,5	10	I	149B 2688	
16	400	10	10	10	10	0,5	8	I	149B 2689	

- Connection : flanges drilled PN : see table
- Permissible operating pressure PFA - water- (for supply, distribution and disposal of water) : See table
- Maximum permissible pressure PS - other mediums: See table
- θ Mini. -10 °C
Maxi. 100 °C
- Mediums : clear liquids, gas
- Approvals : ACS - PED 97/23/CE
- International construction Standards :
CE Conformity Directive 97/23/CE
Flange drilling according to EN1092-2

Overall dimensions

DN "	B		C		D		Weight kg
	mm	mm	mm	mm	mm	mm	
2	50	165	97	100	100	5,8	
2 1/2	65	185	125	120	120	8,1	
3	80	200	150	140	140	10,2	
4	100	220	187	170	170	14,5	
5	125	250	220	200	200	24	
6	150	285	260	230	230	32	
8	200	340	340	288	288	53	
10	250	405	420	354	354	94	
12	300	460	490	395	395	140	
14	350	520	586	472	472	225	
16	400	597	680	560	560	312	

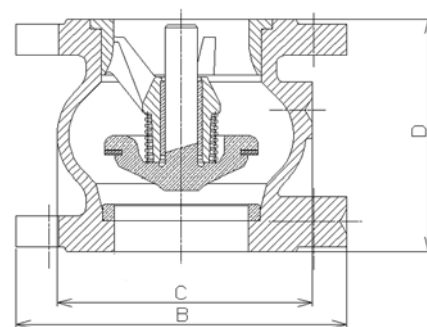

Technical data sheet Type 422 - Non return valve

Spare parts list and materials

Nb	Description	Materials	EURO	ANSI
1	CASING	Cast iron + epoxy	EN 1561 EN-GJL-250	ASTM A 48 35 B
2	RING	Bronze	EN 1982 CuSn12-C GS	
3	GUIDE	Cast iron + epoxy	EN 1561 EN-GJL-250	ASTM A 48 35 B
4	SPRING	Stainless steel	EN 10270-3 X10CrNi18-8	AISI 302
5	SEAL	EPDM		
6	CLOSING SYSTEM	Bronze	EN 1982 CuSn5Zn5Pb2-C GS	
7	SEAT	Bronze	EN 1982 CuSn5Zn5Pb2-C GS	

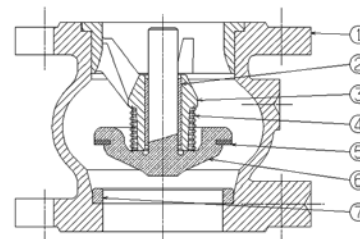

Working principle

DN		Opening pressure in mm/CE				Kv	ζ
"	mm	↑	↓	↔	without spring	m³/H	
2	50	440	220	230	110	99,00	1,00
2 1/2	65	450	190	320	130	159,00	1,10
3	80	450	190	320	130	222,00	1,30
4	100	500	240	370	130	396,00	1,00
5	125	510	210	360	150	619,00	1,00
6	150	550	210	380	170	890,00	1,00
8	200	590	210	400	190	1120,00	2,00
10	250	710	210	460	250	2010,00	1,50
12	300	820	90	460	365	2459,00	2,10
14	350	860	100	480	380	2843,00	2,90
16	400	800	50	410	390	4370,00	2,10

Direction for use:

- Solid line : Valve completely open
- Dotted line : opening stage of valve

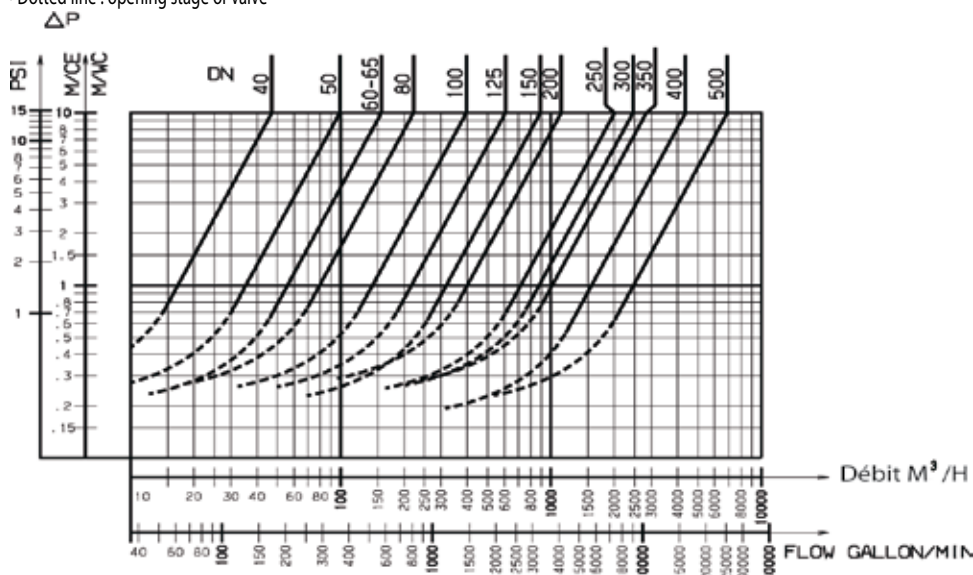

Socla can accept no responsibility for possible errors in catalogue, brochures and other printed material. Socla reserve the right to alter its products without notice. This also applies to products already agreed. All trademarks in this material are the property of the respective companies. All right reserved.

Socla SAS

365 rue du lieutenant Putier
71530 VIREY LE GRAND
Postal address : BP 10273
71107 CHALON SUR SAONE Cedex

Tel : 33 3 85 97 42 52
Fax : 33 3 85 97 97 42
<http://www.socla.com>
e-mail: commerfr@socla.com