

Technical data sheet

Type 412S

Non return valve

System 02

Applications and special features



- Operates in any position
- Minimum head loss
- Silent, reliable sealing, compact
- Exceptional robustness
- Does not generate hammering
- Closing system : long back axial guiding for reduced displacement
- Sealing guaranteed by a flat seal
- Return spring
- Two cable passage notches (submersible pumps)

Technical description

DN "	mm	PN	PFA in bar	PS in bar				Cat.	References	Vvs-nr
				L1	L2	G1	G2			
5	125	25/40	40	16	40	0,5	28	I	149B2254GS	
6	150	25/40	40	13	40	0,5	23	I	149B2255GS	
8	200	40	40	10	40	0,5	17	I	149F017096	
10	250	40	40	10	40	0,5	14	I	149B2277GS	
12	300	40	40	10	40	0,5	11	I	149B2278GS	

Important notice:

The indicated pressure for the different categories of fluids (L1/L2/G1/G2) is under no condition a guarantee of use. Therefore, it is essential to validate the use of products under given operating conditions.

The operating instructions are available on our web site www.socla.com or by requesting from our sales department.

- **Connection** : flanges drilled PN : see table .
- **Permissible operating pressure PFA - water-** (for supply, distribution and disposal of water) : See table
- **Maximum permissible pressure PS - other mediums** : See table
- **T°** : Mini. -10 °C
Maxi. 100 °C
- **Mediums** : clear liquids, gas
- **Approvals** : ACS - PED 97/23/CE
- **International construction Standards** :
CE Conformity Directive 97/23/CE
Flange drilling according to EN1092-2
Overall dimensions adapted to submersible pumps.

Overall dimensions

DN		B	C	D	Weight
"	mm	mm	mm	mm	kg
5	125	190	270	201	20
6	150	212	300	220	27,5
8	200	266	375	280	49,2
10	250	324	450	345	95
12	300	420	515	365	130

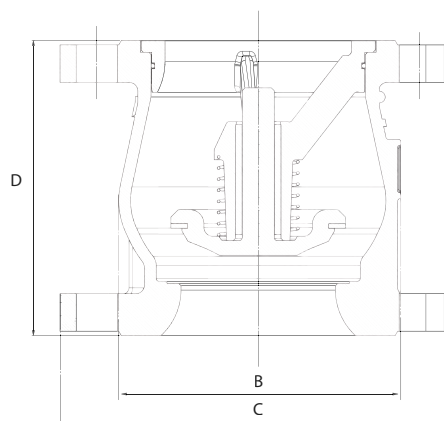

Technical data sheet Type 412S - Non return valve

Spare parts list and materials

Nb	Description	Materials	EURO	ANSI
1	CASING	Ductile iron/epoxy	EN 1563 EN-GJS-400.15	ASTM A 536 65-45-12
2	RING	Bronze	EN 1982 CuSn12-C GS	
3	GUIDE	Cast iron/epoxy	EN 1561 EN-GJL-250	ASTM A 48 35 B
4	SPRING	Stainless steel	EN 10270-3 X10CrNi18-8	AISI 302
5	FLAT SEAL	EPDM		
6	CLOSING SYSTEM	Bronze	EN 1982 CuSn5Zn5Pb2-C GS	
7	O-RING SEAL(exc. 12")	EPDM		

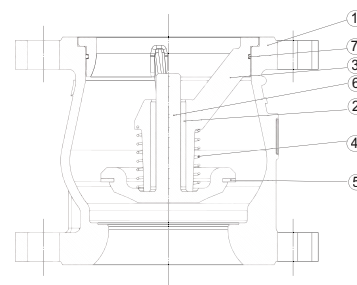

Working principle

DN		Opening pressure in mm/CE				Kv	ζ
"	mm	↑	↓	↔	Without spring	m³/H	
5	125	500	240	370	130	357,00	3,00
6	150	510	210	360	150	476,00	3,50
8	200	550	210	380	170	607,00	6,80
10	250	590	210	400	190	1000,00	6,10
12	300	710	210	460	250	1452,00	6,00

Directions for use :

- Solid line : Valve completely open
- Dotted line : opening stage of valve

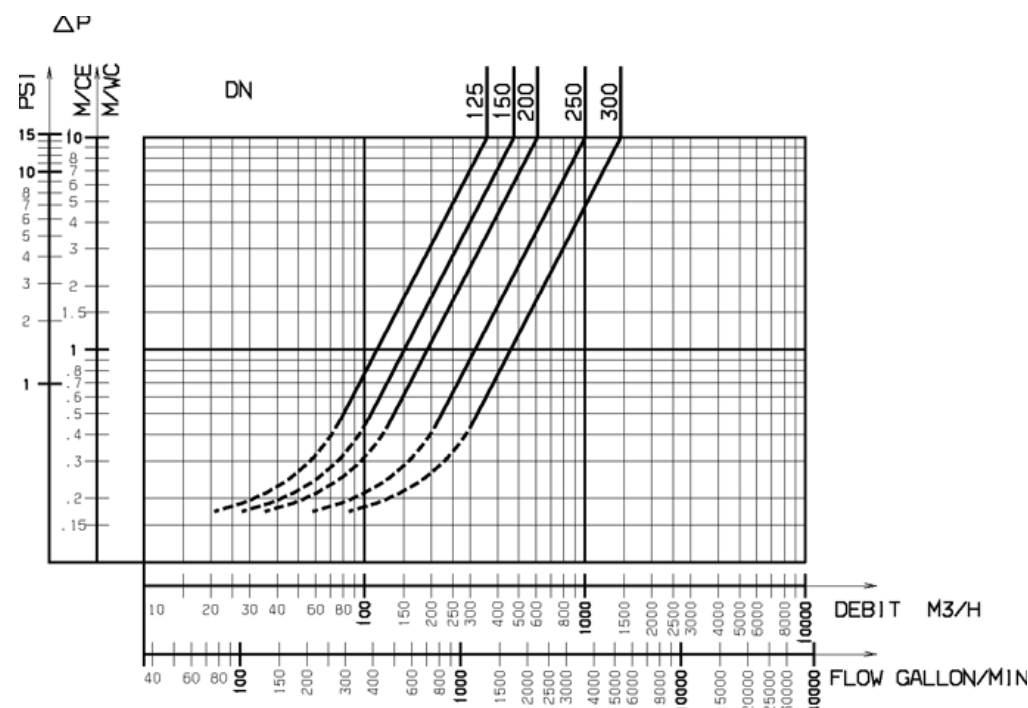

Socla can accept no responsibility for possible errors in catalogue, brochures and other printed material. Socla reserve the right to alter its products without notice. This also applies to products already agreed. All trademarks in this material are the property of the respective companies. All right reserved.

Socla SAS

365 rue du lieutenant Putier
71530 VIREY LE GRAND
Postal address : BP 10273
71107 CHALON SUR SAONE Cedex

Tel : 33 3 85 97 42 52
Fax : 33 3 85 97 97 42
<http://www.socla.com>
e-mail: commerfr@socla.com