

Technical data sheet

Type 407B

Non return-valve
System M

Applications and special features



- Operates in any position
- Low head loss
- Very silent
- Does not generate hammering
- 2 threaded bosses 1/2" with brass plug.
- Closing system : flexible membrane (thick elastomer disc) held in its center on a metal seat consisting of a grid (flow equivalent to the minimal section)
- Sealing ensured by self-closing membrane
- On membrane check valves, the opening regulated by the elasticity and the thickness of the membrane is very progressive and can be obtained as a result of a few centimeters of W/C. Because of this, this check valve is particularly suitable for variable flow pumps and pulsatory operation.

Technical description

DN "	PN mm	PFA in bar	PS in bar				Cat.	References	Vvs-nr
			L1	L2	G1	G2			
1 1/2	40	10/16	16	16	16	16	I	149B 1166	
2	50	10/16	16	16	16	16	I	149B 1167	
2 1/4	60	10/16	16	16	16	16	I	149B 2163	
2 1/2	65	10/16	16	16	15	16	I	149B 1168	
3	80	10/16	16	16	12	16	I	149B 1169	
4	100	10/16	16	16	10	16	I	149B 1170	
5	125	10/16	16	16	0,5	16	I	149B 1171	
6	150	10/16	16	13	0,5	16	I	149B 1172	
8	200	10	10	10	0,5	10	I	149B 1173	

Important notice :

The indicated pressure for the different categories of fluids (L1/L2/G1/G2) is under no condition a guarantee of use. Therefore, it is essential to validate the use of products under given operating conditions.

- **Connection** : flanges drilled PN : see table
- **Permissible operating pressure PFA - water-** (for supply, distribution and disposal of water) : See table
- **Maximum Permissible pressure PS - other mediums:** See table
- **θ** Mini. -10 °C
Maxi. 60 °C
- **Mediums** : Clear liquids, gas
- **Approvals** : ACS (except DN 100 up to 200)



- **International construction Standards** :
CE Conformity Directive 97/23/CE
Flange drilling according to EN1092-2

Overall dimensions

"	A		B		C		D		Weight kg
	mm	mm	mm	mm	mm	mm	mm	mm	
1 1/2	40	148	150	140	6,9				
2	50	158	164	159	8,9				
2 1/4	60	176	183	169	11,9				
2 1/2	65	176	183	169	11,9				
3	80	196	200	212	15,9				
4	100	213	220	234	19,5				
5	125	228	250	250	25,4				
6	150	266	285	324	39,5				
8	200	439	340	426	81,6				

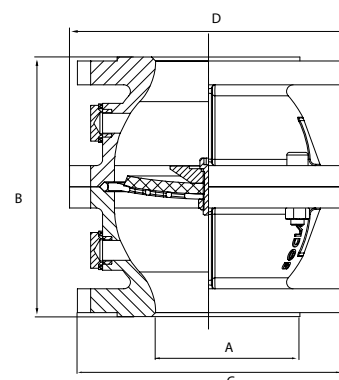

Technical data sheet Type 407B - Non-return valve

Spare parts list and materials

N°	Description	Materials	EURO	ANSI
1	O-RING	EPDM		
2	CASING	Cast iron + epoxy	EN-GJL-250	ASTM A 48 35 B
3	SEAT DN 40 - 80 DN 100 - 200	Stainless steel Steel	CB7Cu-1	
4	CUPEL DN 40 to 65 DN 80 to 200	Stainless steel Brass	X6Cr17 CuZn39Pb3	AISI 430
5	MEMBRANE	NR		
6	BOLT	Stainless steel	X5Cr-Ni18-10	AISI 304
7	SCREW	Stainless steel	X5Cr-Ni18-10	AISI 304
8	BOLT	Stainless steel	X5Cr-Ni18-10	AISI 304
9	SCREW	Stainless steel	X5Cr-Ni18-10	AISI 304
10	PLUG	Brass	CuZn39Pb3	
11	SEAL	EPDM		

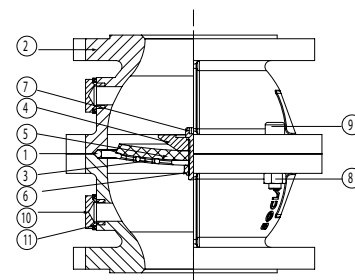

Working principle

DN	Opening pressure in mm/WC	Kv	ζ
"	mm	m³/H	
1 1/2	40	40,30	2,50
2	50	70,50	1,97
2 1/2	65	93,30	3,21
3	80	180,00	1,98
4	100	305,50	1,68
5	125	515,00	1,44
6	150	1072,00	0,70
8	200	1940,00	0,60

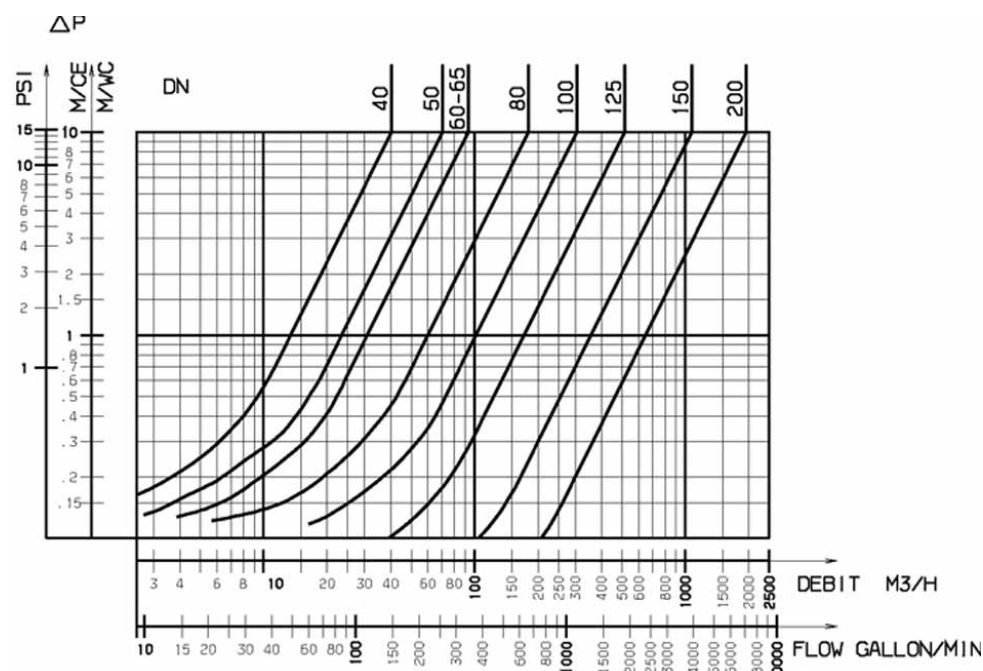

Socla can accept no responsibility for possible errors in catalogue, brochures and other printed material. Socla reserve the right to alter its products without notice. This also applies to products already agreed. All trademarks in this material are the property of the respective companies. All right reserved.

Socla SAS

365 rue du lieutenant Putier
71530 VIREY LE GRAND
Postal address : CS 10273
71107 CHALON SUR SAONE Cedex

Tel : 33 3 85 97 42 52
Fax : 33 3 85 97 97 42
<http://www.socla.com>
e-mail: commerfr@socla.com