

Technical data sheet

Type 402S

Non-return valve

System 02

Applications and special features



- Operates in any position
- Minimum head loss
- Silent, reliable sealing, compact
- Exceptional robustness
- Does not generate hammering
- Closing system : long back axial guiding for reduced displacement
- Sealing guaranteed by a flat seal
- Return spring

Technical description

DN "	mm	PN	PFA bar	PS - bar				Cat.	References	Vvs-nr
				L1	L2	G1	G2			
1 ^{1/2}	40	25/40	40	40	40	25	40	I	149B 2281GS	
1 ^{1/2}	40	25/40	40	40	40	40	40	II	149B 018804	
2	50	25/40	40	40	40	20	40	I	149B 2282GS	
2	50	25/40	40	40	40	40	40	II	149B 018805	
2 ^{1/2}	65	25/40	40	30	40	15	40	I	149B 2283GS	
2 ^{1/2}	65	25/40	40	40	40	40	40	II	149B 018806	
3	80	25/40	40	25	40	12	40	I	149B 2284GS	
3	80	25/40	40	40	40	40	40	II	149B 018810	
4	100	25/40	40	20	40	10	40	I	149B 2285GS	
4	100	25/40	40	40	40	40	40	II	149B 018811	
5	125	25/40	40	16	40	0,5	28	I	149B 2226GS	
5	125	25/40	40	40	40	28	40	II	149B 018812	
6	150	25/40	40	13	40	0,5	23	I	149B 2227GS	
6	150	25/40	40	40	40	23	33	II	149B 018813	
8	200	25	25	25	25	17	25	II	149B 2229GS	
10	250	25	25	25	25	14	20	II	149B 2230GS	
12	300	25	25	25	25	11	16	II	149B 2231GS	
14	350	25	25	25	25	10	14	II	149B 2232GS	
16	400	25	25	25	25	0,5	12	II	149B 2233GS	
18	450	25	25	10	25	0,5	7	I	149B 24822	
20	500	25	25	25	25	0,5	10	II	149B 2235GS	

Important notice :

The indicated pressure for the different categories of fluids (L1/L2/G1/G2) is under no condition a guarantee of use. Therefore, it is essential to validate the use of products under given operating conditions.

The operating instructions are available on our web site www.socla.com or by requesting from our sales department.

- Connection : Flanges drilled PN : see table
- Permissible operating pressure PFA - water (for supply, distribution and disposal of water) : See table
- Maximum permissible pressure PS - other mediums: See table

• θ Mini. -10 °C
Maxi. 100 °C

• Mediums : Clear liquids, gas

• Approvals : ACS PED 97/23/CE

- International construction Standards :
CE Conformity Directive 97/23/CE
Flange drilling according to EN1092-2

Overall dimensions

DN "	mm	B mm	C mm	D mm	Weight Kg
1 ^{1/2}	40	85	85	150	4,2
2	50	100	108	165	5,8
2 ^{1/2}	65	120	131	185	8,1
3	80	140	154	200	10,2
4	100	170	191	235	14,5
5	125	200	224	270	24
6	150	230	266	300	32
8	200	290	346	360	53
10	250	354	424	425	94
12	300	396	494	485	140
14	350	473	590	555	225
16	400	560	684	620	312
18	450	560	684	670	342
20	500	750	884	670	540

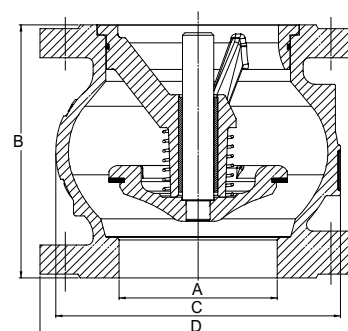

Technical data sheet Type 402S - Non-return valve

Spare parts list and materials

Nb	Description	Materials	EURO	ANSI
1	CASING	Ductile iron/epoxy	EN 1563 EN-GJS-400-15	ASTM A 536 65-45-12
2	O-RING SEAL DN40-250	EPDM		
3	RING	Bronze	EN 1982 CuSn12-C GS	
4	GUIDE DN50	Bronze	EN 1982 CuSn5Zn5Pb2-C GS	ASTM A 48 35 B ASTM A 536 65-45-12
	DN 40 & 65-450*	Cast iron/epoxy	EN 1561 EN-GJL-250	
	DN 500	Ductile iron/epoxy	EN 1563 EN-GJS-400-15	
5	SPRING	Stainless steel	EN 10270-3 X10CrNi18-8	AISI 302
6	FLAT SEAL	EPDM		
7-8	CLOSING SYSTEM DN40	Brass	EN12164CuZn40Pb2 R360 mini	ASTM A 536 65-45-12
	DN50-250	Bronze	EN 1982 CuSn5Zn5Pb2-C GS	
	DN 300-450 STEM VALVE	Bronze	EN 1982 CuSn5Zn5Pb2-C GS	
	DN 500 STEM VALVE	Ductile iron/epoxy	EN 1563 EN-GJS-400-15	
	DN 500 STEM VALVE	Bronze	EN 1982 CuSn12-C GS	
	DN 500 STEM VALVE	Ductile iron/epoxy	EN 1563 EN-GJS-400-15	ASTM A 536 65-45-12

* DN450 : 6 screws to block the guide

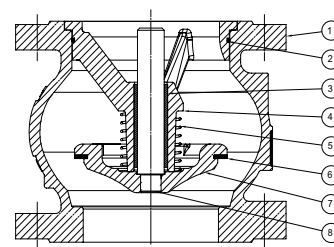

Working principle

DN		Opening pressure in mm/WC				Kv m³/H	ζ
"	mm	↑	↓	↔	Without spring		
1 1/2	40	440	210	320	120	47,00	1,80
2	50	440	220	330	110	99,00	1,00
2 1/2	65	450	190	320	130	159,00	1,10
3	80	450	190	320	130	222,00	1,30
4	100	500	240	370	130	396,00	1,00
5	125	510	210	360	150	619,00	1,00
6	150	550	210	380	170	890,00	1,00
8	200	590	210	400	190	1120,00	2,00
10	250	710	210	460	250	2010,00	1,50
12	300	820	90	460	365	2459,00	2,10
14	350	860	100	480	380	2843,00	2,90
16	400	800	50	410	390	4370,00	2,10
18	450	800	50	410	390	4370,00	2,10
20	500	1030	0	430	580	6914,00	2,05

Direction for use :

- Solid line : Valve completely open
- Dotted line : opening stage of valve

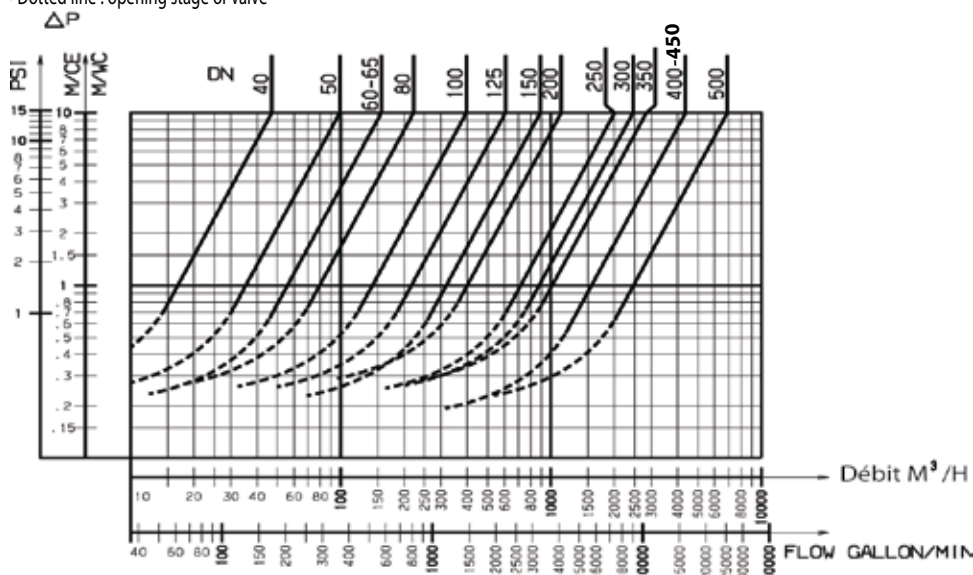

Socla can accept no responsibility for possible errors in catalogue, brochures and other printed material. Socla reserve the right to alter its products without notice. This also applies to products already agreed. All trademarks in this material are the property of the respective companies. All right reserved.

Socla SAS

365 rue du lieutenant Putier
71530 VIREY LE GRAND
Postal address : CS 10273
71107 CHALON SUR SAONE Cedex

Tel : 33 3 85 97 42 52
Fax : 33 3 85 97 97 42
<http://www.socla.com>
e-mail: commerfr@socla.com