

Technical data sheet

Type 212S

Non return valve

System 02

Applications and special features



- Operates in any position
- Minimum head loss
- Silent, reliable sealing, compact
- Exceptional robustness
- Does not generate hammering
- Closing system : long back axial guiding for reduced displacement
- Sealing guaranteed by a flat seal
- Return spring

Technical description

DN "	mm	PFA in bar	PS in bar				Cat.	References	Vvs-nr
			L1	L2	G1	G2			
2 1/2	65	40	30	40	15	40	I	149B2454GS	
3	80	40	25	40	12	40	I	149B2455GS	
4	100	40	20	40	10	35	I	149B2456GS	
5	125	40	16	40	0,5	28	I	149B2257GS	
6	150	40	13	40	0,5	23	I	149B2258GS	
8	200	40	10	40	0,5	17	I	149B2259GS	

Important notice :

The indicated pressure for the different categories of fluids (L1/L2/G1/G2) is under no condition a guarantee of use. Therefore, it is essential to validate the use of products under given operating conditions. In order to facilitate your choice regarding these new regulatory requirements,

- **Connection** : Male/female (BSP)
- **Permissible operating pressure PFA - water-** (for supply, distribution and disposal of water) : see table
- **Maximum permissible pressure PS - other mediums** : See table

• **θ** : Mini. -10 °C
Maxi. 100 °C

• **Mediums** : clear liquids, gas

• **Approvals** : ACS - CE PED 97/23/CE



• **Other approval available** : VA : Please consult us

• **International construction Standards** :
CE Conformity Directive 97/23/CE
Thread connection NF EN ISO 228-1
Overall dimensions adapted to submersible pumps

Overall dimensions

A		B		C		Weight kg
"	mm	mm	mm	mm	mm	
2 1/2	65	139	99	2,7		
3	80	165	127	5,3		
4	100	195	152	8,7		
5	125	230	190	14,0		
6	150	275	225	21,2		
8	200	333	268	41,8		

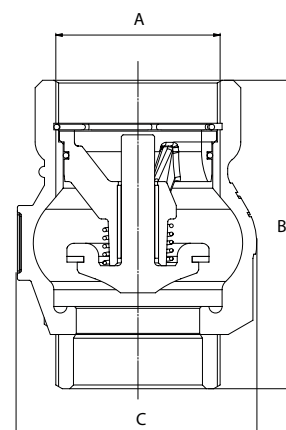

Technical data sheet Type 212S - Non return valve

Spare parts list and materials

Nb	Description	Materials	EURO	ANSI
1	CASING	Ductile iron/ Epoxy	EN 1563 EN-GJS-400-15	ASTM A 536 65-45-12
2	RING (except 2"1/2)	Bronze	EN 1982 CuSn12-C GS	
3	GUIDE DN 2 1/2	Bronze	EN 1982 CuSn5Zn5Pb2-C GS	
	Other DN	Cast iron/ Epoxy	EN 1561 EN-GJL-250	ASTM A 48 35 B
4	SPRING	Stainless steel	EN 10270-3 X10CrNi18-8	AISI 302
5	FLAT SEAL	EPDM		
6	CLOSING SYSTEM 2"1/2-5"	Bronze	EN 1982 CuSn5Zn5Pb2-C GS	
	DN 6"-8" STEM/CLOSING SYST	Bronze	EN 1982 CuSn5Zn5Pb2-C GS	
7	O-RING	EPDM		
8	BANGLE 2"1/2 - 4"	Stainless steel	EN 10270-3 X10CrNi18-8	AISI 302

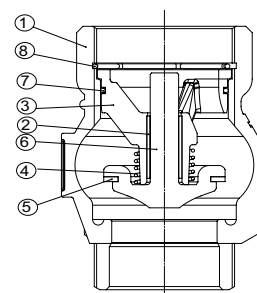

Working principle

DN		Opening pressure in mm/CE				Kv	ζ
"	mm	↑	↓	↔	Without spring	m³/H	
2 1/2	65	440	220	330	110	88,00	3,60
3	80	450	190	320	130	132,00	3,70
4	100	150	190	320	130	205,00	3,70
5	125	500	240	370	130	316,00	3,80
6	150	510	210	360	150	533,00	2,80
8	200	550	210	380	150	533,00	2,80

Directions for use :

- Solid line : Valve completely open
- Dotted line : Opening stage of the valve

ΔP

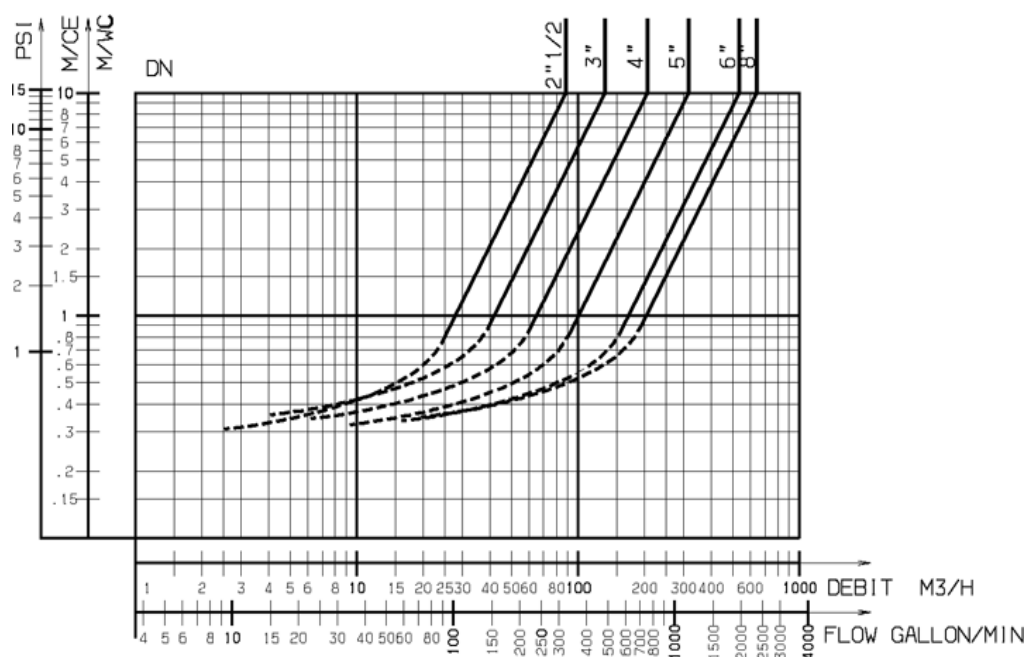

Socla can accept no responsibility for possible errors in catalogue, brochures and other printed material. Socla reserve the right to alter its products without notice. This also applies to products already agreed. All trademarks in this material are the property of the respective companies. All right reserved.

Socla SAS

365 rue du lieutenant Putier
71530 VIREY LE GRAND
Postal address : BP 10273
71107 CHALON SUR SAONE Cedex

Tel : 33 3 85 97 42 52
Fax : 33 3 85 97 97 42
<http://www.socla.com>
e-mail: commer@socla.com