

## Technical data sheet

### Type 102PV

Foot valve  
System 02

#### Applications and special features



- Operates in any position from horizontal to vertical ascending
- Minimum head loss
- Silent, reliable sealing, compact
- Exceptional robustness
- Does not generate hammering
- Closing system : long back axial guiding for reduced displacement
- Sealing guaranteed by a FKM flat seal
- Return spring

#### Technical description

| DN               | PFA<br>in bar | PS in bar |    |    |    | Cat. | References | Vvs-nr    |
|------------------|---------------|-----------|----|----|----|------|------------|-----------|
|                  |               | L1        | L2 | G1 | G2 |      |            |           |
| 2 <sup>1/4</sup> | 60            | 16        | 16 | 16 | x  | x    | 3.3        | 149B 2762 |
| 2 <sup>1/2</sup> | 65            | 16        | 16 | 16 | x  | x    | 3.3        | 149B 2763 |
| 3                | 80            | 16        | 16 | 16 | x  | x    | 3.3        | 149B 2764 |
| 4                | 100           | 16        | 16 | 16 | x  | x    | 3.3        | 149B 2765 |

#### Important notice :

The indicated pressure for the different categories of fluids (L1/L2/G1/G2) is under no condition a guarantee of use.  
Therefore, it is essential to validate the use of products under given operating conditions.

- **Connection** : Female, (BSP)
- **Permissible operating pressure PFA - water-** (for supply, distribution and disposal of water) : See table
- **Maximum permissible pressure PS - other mediums** : See table
- **T°** : Mini. -10 °C  
Maxi. 80 °C
- **Mediums** : Clear liquids, hydrocarbons
- **Approvals** : Bureau Veritas
- **International construction Standards** : Directive 97/23/CE  
Thread connection NF EN ISO 228-1

#### Overall dimensions

|                  | A       | B   | C   | F   | Weight |
|------------------|---------|-----|-----|-----|--------|
| "                | mm      | mm  | mm  | mm  | kg     |
| 2 <sup>1/4</sup> | 60/70   | 195 | 97  | 123 | 3      |
| 2 <sup>1/2</sup> | 66/76   | 195 | 97  | 124 | 3      |
| 3                | 80/90   | 241 | 125 | 152 | 5      |
| 4                | 102/114 | 290 | 150 | 180 | 8      |

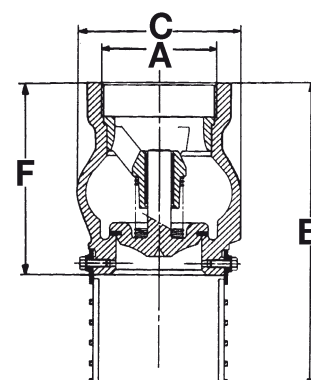

## Technical data sheet Type 102PV - Foot valve

### Spare parts list and materials

| Nb | Description                               | Materials         | EURO                     | ANSI           |
|----|---|-------------------|--------------------------|----------------|
| 1  | CASING                                    | Cast iron/Epoxy   | EN 1561 EN-GJL-250       | ASTM A 48 35 B |
| 2  | STEM 4"                                   | Bronze            | EN 1982 CuSn5Zn5Pb2-C GS |                |
| 3  | GUIDE 2 <sup>1/4</sup> - 2 <sup>1/2</sup> | Bronze            | EN 1982 CuSn5Zn5Pb2-C GS |                |
|    | Other DN                                  | Cast iron/Epoxy   | EN 1561 EN-GJL-250       | ASTM A 48 35 B |
| 4  | RING                                      | Bronze            | EN 1982 CuSn12-C GS      |                |
| 5  | SPRING                                    | Stainless steel   | EN 10270-3 X10CrNi18-8   | AISI 302       |
| 6  | SEAL                                      | FKM               |                          |                |
| 7  | CLOSING SYSTEM 4"                         | Cast iron/Epoxy   | EN 1561 EN-GJL-250       | ASTM A 48 35 B |
|    | Other DN : one-piece                      | Bronze            | EN 1982 CuSn5Zn5Pb2-C GS |                |
| 8  | SCREW                                     | Galvanised steel  |                          |                |
| 9  | STRAINER                                  | PP (Polypropylen) |                          |                |

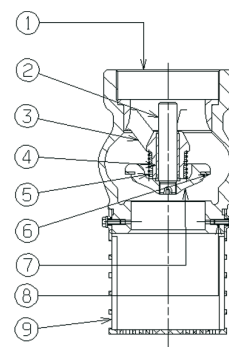

### Working principle

| DN    |     | Opening pressure in mm/CE |                | Kv     | ζ    |
|-------|-----|---------------------------|----------------|--------|------|
| "     | mm  | ↑                         | Without spring | m³/H   |      |
| 2 1/4 | 60  | 230                       | 110            | 82,00  | 3,00 |
| 2 1/2 | 65  | 230                       | 110            | 82,00  | 4,20 |
| 3     | 80  | 240                       | 130            | 120,00 | 4,40 |
| 4     | 100 | 280                       | 130            | 188,00 | 4,40 |

#### Directions for use :

- Solid line : Valve completely open
- Dotted line : opening stage of valve

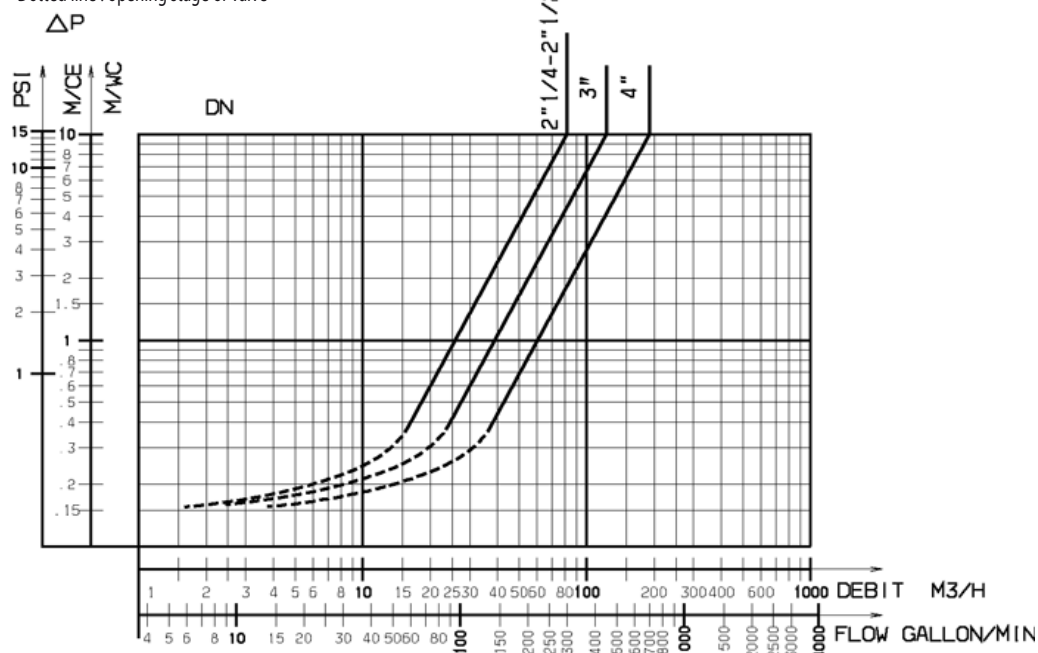

Socla can accept no responsibility for possible errors in catalogue, brochures and other printed material. Socla reserve the right to alter its products without notice. This also applies to products already agreed. All trademarks in this material are the property of the respective companies. All right reserved.

### Socla SAS

365 rue du lieutenant Putier  
71530 VIREY LE GRAND  
Postal address : BP 10273  
71107 CHALON SUR SAONE Cedex

Tel : 33 3 85 97 42 52  
Fax : 33 3 85 97 97 42  
<http://www.socla.com>  
e-mail: [commer@socla.com](mailto:commer@socla.com)