

## Technical data sheet

### Type 102P

Foot valve

System 02

#### Applications and special features



- Operates in any position from horizontal to vertical ascending
- Minimum head loss
- Silent, reliable sealing, compact
- Exceptional robustness
- Does not generate hammering
- Closing system : long back axial guiding for reduced displacement
- Sealing guaranteed by a flat seal
- Return spring

#### Technical description

DN	PFA in bar	PS in bar				Cat.	References	Vvs-nr
		L1	L2	G1	G2			
2 <sup>1/4</sup>	60	16	16	16	x	3.3	149B 2758	
2 <sup>1/2</sup>	65	16	16	16	x	3.3	149B 2759	
3	80	16	16	16	x	3.3	149B 2760	
4	100	16	16	16	x	3.3	149B 2761	

##### Important notice :

The indicated pressure for the different categories of fluids (L1/L2/G1/G2) is under no condition a guarantee of use. Therefore, it is essential to validate the use of products under given operating conditions.

- **Connection** : Female, (BSP)
- **Permissible operating pressure PFA - water-** (for supply, distribution and disposal of water) : See table
- **Maximum permissible pressure PS - other mediums:** See table
- **θ** Mini. -10 °C  
Maxi. 80 °C
- **Mediums** : Clear liquids
- **Approvals** : ACS -
- **International construction Standards** :  
Directive 97/23/CE  
Thread connection NF EN ISO 228-1

#### Overall dimensions

	A	B	C	F	Weight
"	mm	mm	mm	mm	kg
2 <sup>1/4</sup>	60/70	195	97	123	3
2 <sup>1/2</sup>	66/76	195	97	124	3
3	80/90	241	125	152	5
4	102/114	290	150	180	8

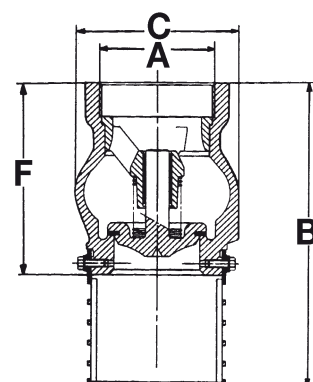

## Technical data sheet Type 102P - Foot valve

### Spare parts list and materials

Nb	Description	Materials	EURO	ANSI
1	CASING	Cast iron + epoxy	EN 1561 EN-GJL-250	ASTM A 48 35 B
2	STEM 4"	Bronze	EN 1982 CuSn5Zn5Pb2-C GS	
3	GUIDE 2 1/4" - 2 1/2"	Bronze	EN 1982 CuSn5Zn5Pb2-C GS	
4	Other DN	Cast iron + epoxy	EN 1561 EN-GJL-250	ASTM A 48 35 B
4	RING	Bronze	EN 1982 CuSn12-C GS	
5	SPRING	Stainless steel	EN 10270-3 X10CrNi18-8	AISI 302
6	SEAL	EPDM		
7	CLOSING SYSTEM 4"	Cast iron + epoxy	EN 1561 EN-GJL-250	ASTM A 48 35 B
7	Other DN : one-piece	Bronze	EN 1982 CuSn5Zn5Pb2-C GS	
8	SCREW	Galvanised steel		
9	STRAINER	PP (polypropylen)		

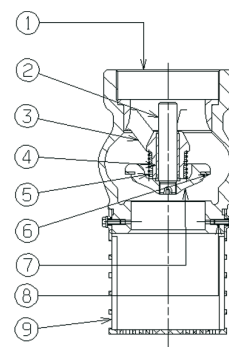

### Working principle

DN		Opening pressure in mm/CE		Kv	ζ
"	mm	↑	Without spring	m³/H	
2 1/4	60	230	110	82,00	3,00
2 1/2	65	230	110	82,00	4,20
3	80	240	130	120,00	4,40
4	100	280	130	188,00	4,40

#### Directions for use :

- Solid line : Valve completely open
- Dotted line : opening stage of valve

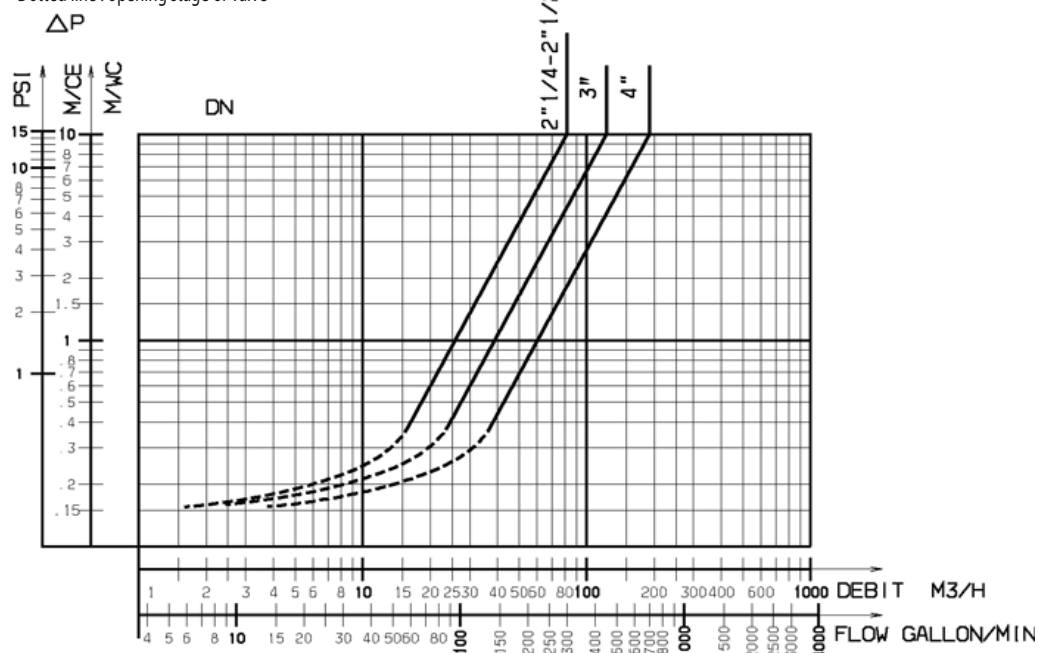

Socla can accept no responsibility for possible errors in catalogue, brochures and other printed material. Socla reserve the right to alter its products without notice. This also applies to products already agreed. All trademarks in this material are the property of the respective companies. All right reserved.

### Socla SAS

365 rue du lieutenant Putier  
71530 VIREY LE GRAND  
Postal address : BP 10273  
71107 CHALON SUR SAONE Cedex

Tel : 33 3 85 97 42 52  
Fax : 33 3 85 97 97 42  
<http://www.socla.com>  
e-mail: [commer@socla.com](mailto:commer@socla.com)